



**PATERNOSTERS.  
EXPOSITORS FOR FLOOR  
COVERINGS**



**IPRIS-PROFIL**

Ukraine, Kharkiv, 61106, 12, Plytkova street,  
tel.: +38 (057) 744-10-00, e-mail: [info@ipris-profil.com](mailto:info@ipris-profil.com)  
[www.ipris-profil.com](http://www.ipris-profil.com)

## ABOUT US

The company "Ipris-Profil" was founded in 2003 as a manufacturer of electric-welded tubes and storage equipment. The closed cycle of production allows us to provide high quality products and to achieve stable and timely deliveries.

## OUR ADVANTAGES



CLOSED PRODUCTION CYCLE



INDIVIDUAL APPROACH



INNOVATIVE TECHNOLOGIES



MORE THAN 15 YEARS OF EXPERIENCE



QUALITY CONTROL SYSTEM



PRODUCTION IN SHORT TERMS



The key factor of success is our own full production line, with a set of modern and automatic equipment.

## OUR PRODUCTION EQUIPMENT

- ◆ 2 automatic powder-paint lines
- ◆ Cold galvanizing workshop
- ◆ 2 Steel Pipe Production Lines
- ◆ 3D bending machine
- ◆ more than 400 highly skilled employees
- ◆ CNC milling machines
- ◆ CNC laser cutting machines
- ◆ Own tool workshop

We are ready to manufacture metal solutions for product transportation into account to your business needs. We develop, plan and execute customized and cost-effective product solutions that serve the interest of your business.

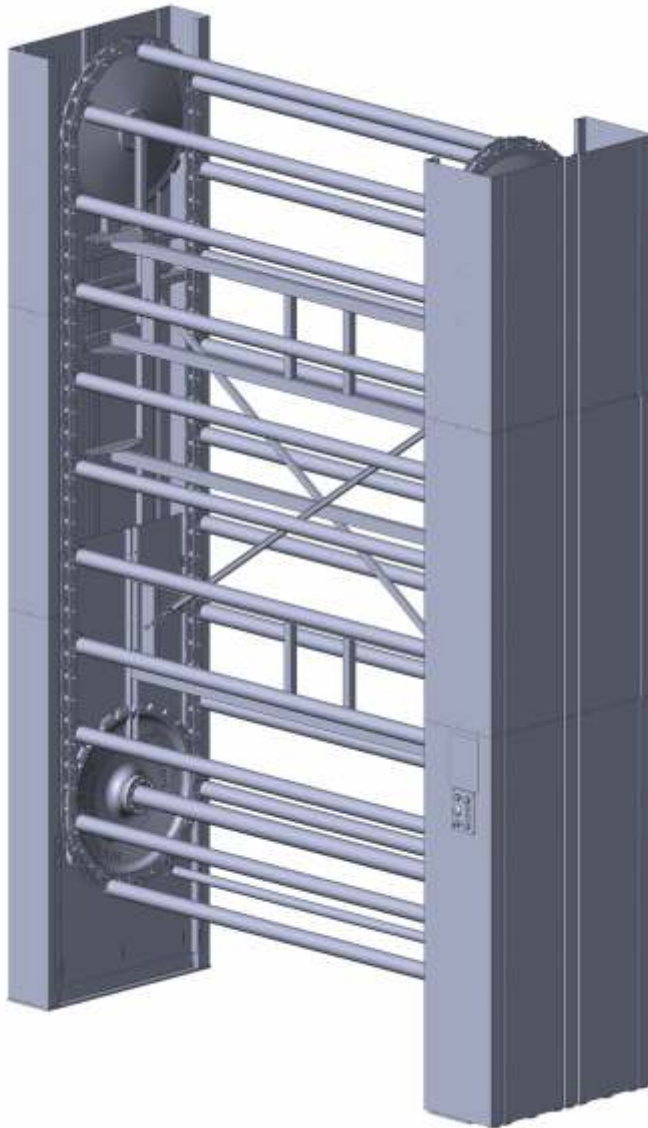

**PATERNOSTER FOR ROLL MATERIALS**

Paternoster for linoleum / carpet is a stand for 10-31 rolls (max 660 mm).

The number of paternoster loading axes in the table is indicated for linoleum and carpet of standard diameter (380-580 mm). If necessary, you can change the distance between the axes of the loading in 100 mm increments.

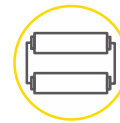

**Hanging step**  
400/600 mm



**Power consumption**  
1.5 kW



**Voltage**  
380/220 V



**Rated frequency**  
50 Hz

| Number of rolls d 380 mm | Conditional paternoster height H, mm | Paternoster overall height (per roll), mm | Linoleum width, mm |           |           |           |           |           | Drive power, kW / V |
|--------------------------|--------------------------------------|---|--------------------|-----------|-----------|-----------|-----------|-----------|---------------------|
|                          |                                      |   | Vendor code        |           |           |           |           |           |                     |
|                          |                                      |   | 2000               | 2500      | 3000      | 3500      | 4000      | 5000      |                     |
| 16                       | 3500                                 | 3480                                      | A203516CA          | A253516CA | A303516CA | A353516CA | A403516CA | A403516CA | 1,5/220             |
| 18                       | 3900                                 | 3880                                      | A203518CA          | A253518CA | A303518CA | A353518CA | A403518CA | A403518CA |                     |
| 18                       | 4000                                 | 3980                                      | A204018CA          | A254018CA | A304018CA | A354018CA | A404018CA | A404018CA |                     |
| 19                       | 4200                                 | 4180                                      | A204219CA          | A254219CA | A304219CA | A354219CA | A404219CA | A404219CA |                     |
| 21                       | 4500                                 | 4480                                      | A204521CA          | A254521CA | A304521CA | A354521CA | A404521CA | A404521CA |                     |
| 23                       | 5000                                 | 4980                                      | A205023CA          | A255023CA | A305023CA | A355023CA | A405023CA | A405023CA |                     |
| 26                       | 5500                                 | 5480                                      | A205526CA          | A255526CA | A305526CA | A355526CA | A405526CA | A405526CA |                     |
| 27                       | 5700                                 | 5780                                      | A205727CA          | A255727CA | A305727CA | A355727CA | A405727CA | A405727CA | 2,2/220             |
| 28                       | 6000                                 | 6080                                      | A206028CA          | A256028CA | A306028CA | A356028CA | A406028CA | A406028CA |                     |
| 31                       | 6600                                 | 6680                                      | A206631CA          | A256631CA | A306631CA | A356631CA | A406631CA | A406631CA |                     |

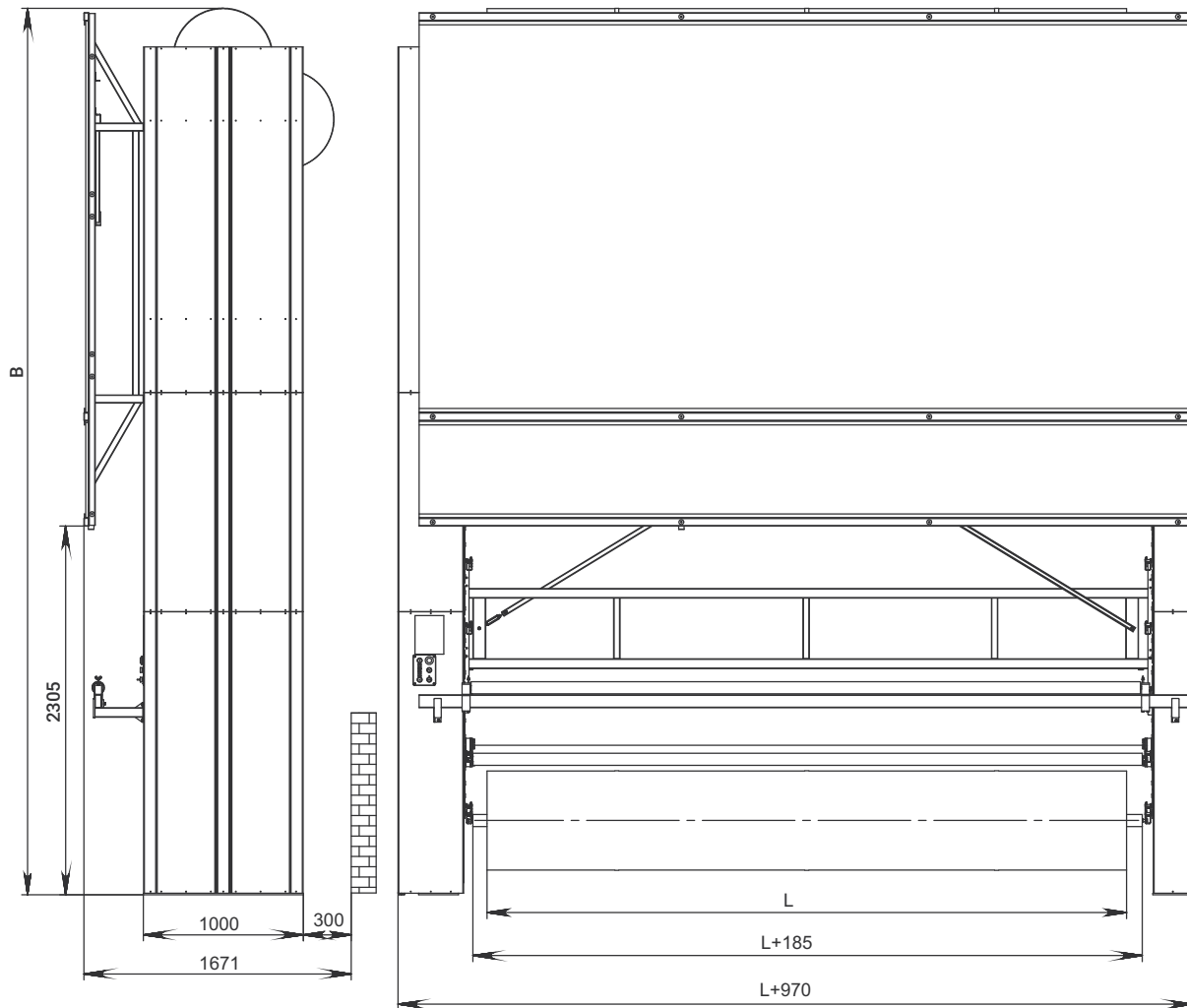

| Roll width, mm | Paternoster width, mm | Paternoster depth, mm |
|----------------|-----------------------|-----------------------|
| 2000           | 2970                  | 1000                  |
| 2500           | 3470                  |                       |
| 3000           | 3970                  |                       |
| 3500           | 4470                  |                       |
| 4000           | 4970                  |                       |
| 5000           | 5970                  |                       |

| Number of rolls d580 mm | Conditional paternoster height H, mm | Paternoster overall height (per roll), mm | Carpet width, mm |           |           |           |           |           | Drive power, kW / V |         |
|-------------------------|--------------------------------------|---|------------------|-----------|-----------|-----------|-----------|-----------|---------------------|---------|
|                         |                                      |   | Vendor code      |           |           |           |           |           |                     |         |
|                         |                                      |   | 2000             | 2500      | 3000      | 3500      | 4000      | 5000      |                     |         |
| 10                      | 3500                                 | 3580                                      | A203510CE        | A253510CE | A303510CE | A353510CE | A403510CE | A503510CE | 1,5/220             |         |
| 12                      | 3900                                 | 3980                                      | A203512CE        | A253512CE | A303512CE | A353512CE | A403512CE | A503512CE |                     |         |
| 12                      | 4000                                 | 4080                                      | A204012CE        | A254012CE | A304012CE | A354012CE | A404012CE | A504012CE |                     |         |
| 13                      | 4200                                 | 4280                                      | A204213CE        | A254213CE | A304213CE | A354213CE | A404213CE | A504213CE |                     |         |
| 14                      | 4500                                 | 4580                                      | A204514CE        | A254514CE | A304514CE | A354514CE | A404514CE | A504514CE |                     |         |
| 16                      | 5000                                 | 5080                                      | A205016CE        | A255016CE | A305016CE | A355016CE | A405016CE | A505016CE |                     |         |
| 17                      | 5500                                 | 5580                                      | A205517CE        | A255517CE | A305517CE | A355517CE | A405517CE | A505517CE |                     |         |
| 18                      | 5700                                 | 5780                                      | A205718CE        | A255718CE | A305718CE | A355718CE | A405718CE | A505718CE |                     |         |
| 19                      | 6000                                 | 6080                                      | A206019CE        | A256019CE | A306019CE | A356019CE | A406019CE | A506019CE |                     | 2,2/220 |
| 21                      | 6600                                 | 6680                                      | A206620CE        | A256620CE | A306620CE | A356620CE | A406620CE | A506620CE |                     |         |

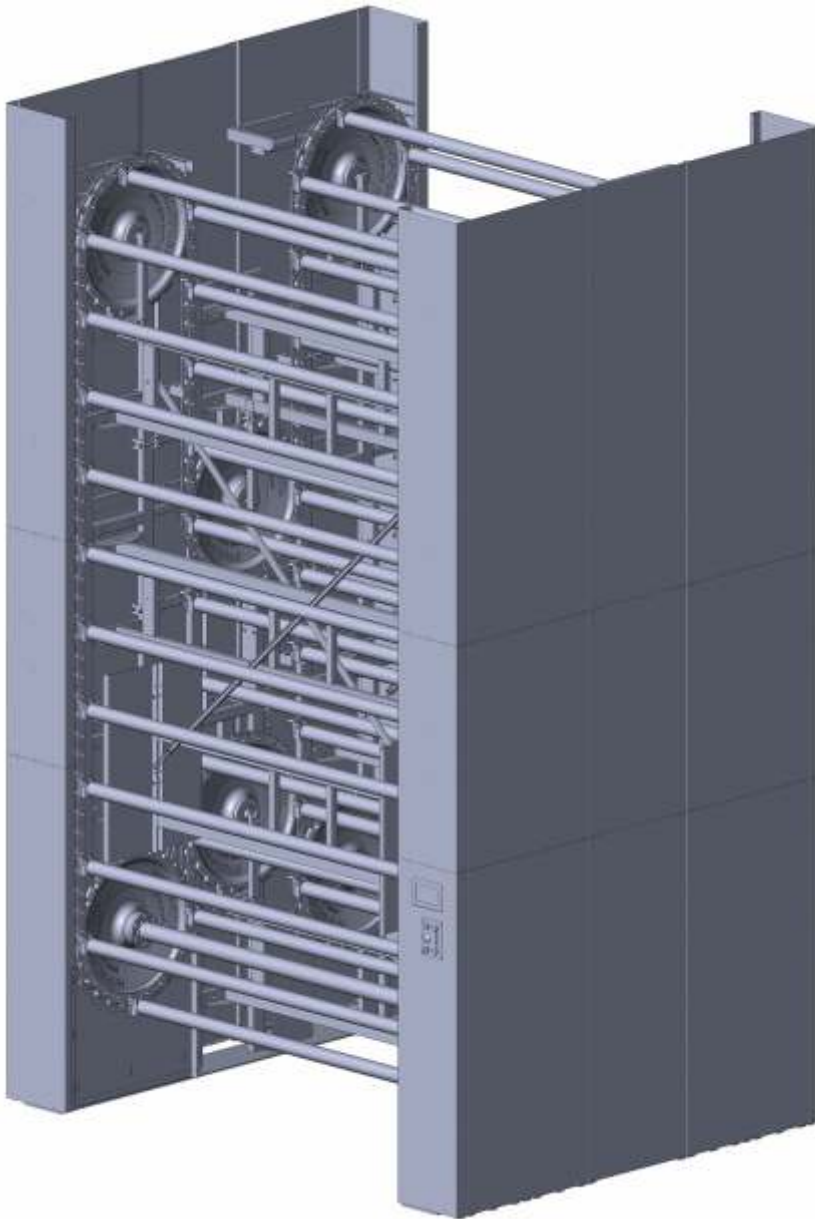
**MULTI-ROW PATERNOSTER FOR ROLLED MATERIALS «SLADOCK» M2**

Paternoster Sladock M2 and M3 allows you to arrange a large number of goods (rolls) on a small area, while it has a demonstration area.



**Power consumption**  
1.5 kW



**Voltage**  
380/220 V



**Rated frequency**  
50 Hz

| Number of rolls d580 mm | Conditional paternoster height H, mm | Paternoster overall height (per roll), mm | Carpet width, mm |            |            |            |            |            |            | Drive power, kW / V |
|-------------------------|--------------------------------------|---|------------------|------------|------------|------------|------------|------------|------------|---------------------|
|                         |                                      |   | Vendor code      |            |            |            |            |            |            |                     |
|                         |                                      |   | 2000             | 2500       | 3000       | 3500       | 4000       | 4500       | 5000       |                     |
| 30                      | 5000                                 | 5080                                      | A205030M2M       | A255030M2M | A305030M2M | A355030M2M | A405030M2M | A455030M2M | A505030M2M | 1,5/220             |

| Number of rolls d380 mm | Conditional paternoster height H, mm | Paternoster overall height (per roll), mm | Carpet width, mm |            |            |            |            |            |            | Drive power, kW / V |
|-------------------------|--------------------------------------|---|------------------|------------|------------|------------|------------|------------|------------|---------------------|
|                         |                                      |   | Vendor code      |            |            |            |            |            |            |                     |
|                         |                                      |   | 2000             | 2500       | 3000       | 3500       | 4000       | 4500       | 5000       |                     |
| 45                      | 5000                                 | 5080                                      | A205045M2M       | A255045M2M | A305045M2M | A355045M2M | A405045M2M | A455045M2M | A505045M2M | 1,5/220             |

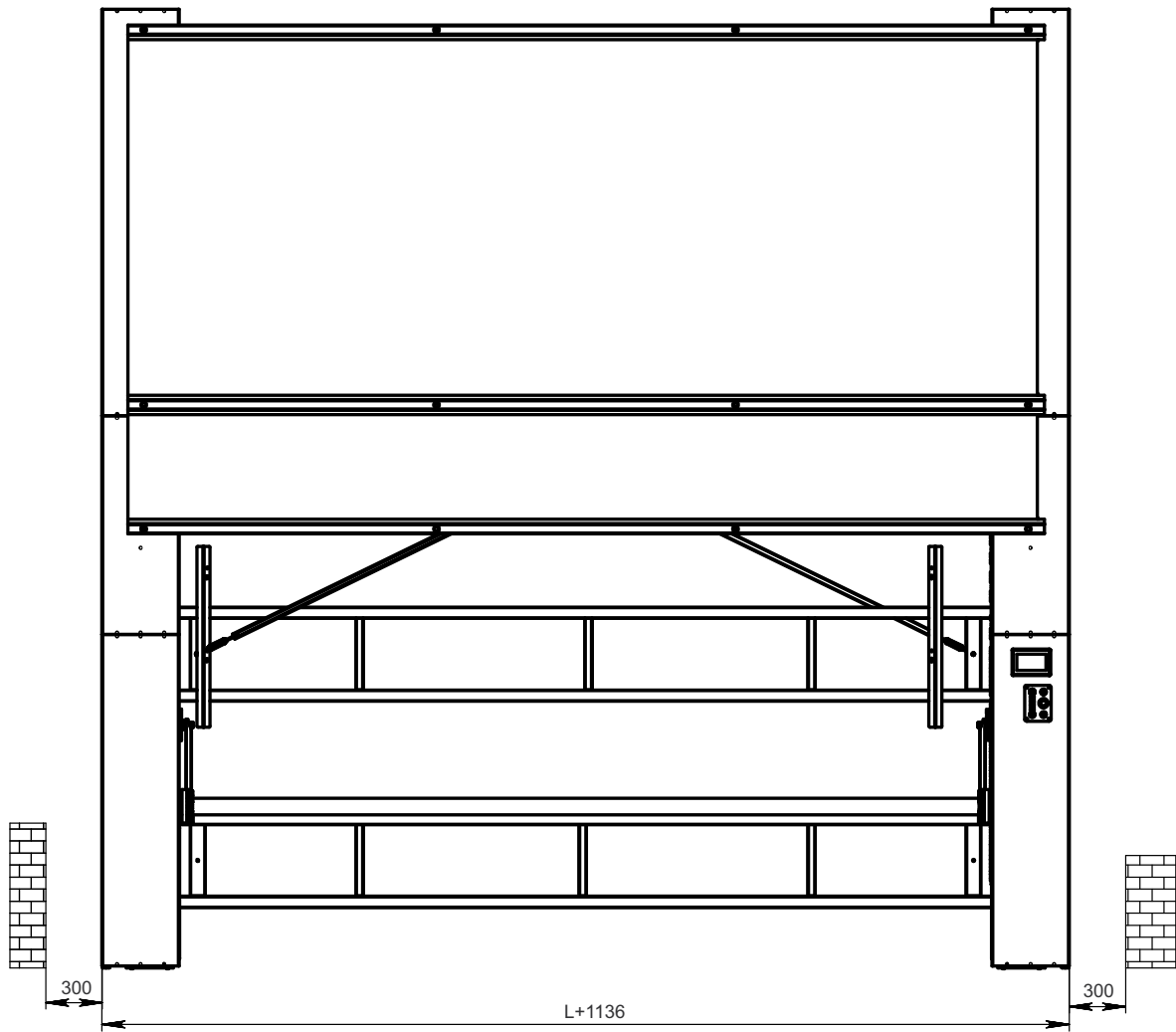

| Roll width, mm | Paternoster width, mm | Paternoster depth, mm |
|----------------|-----------------------|-----------------------|
| 2000           | 3136                  | 2532                  |
| 2500           | 3636                  |                       |
| 3000           | 4136                  |                       |
| 3500           | 4636                  |                       |
| 4000           | 5136                  |                       |

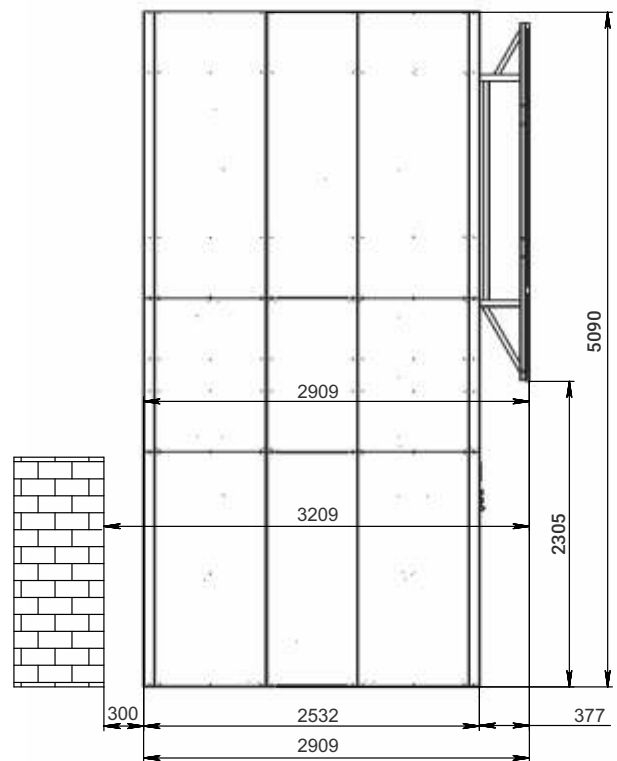

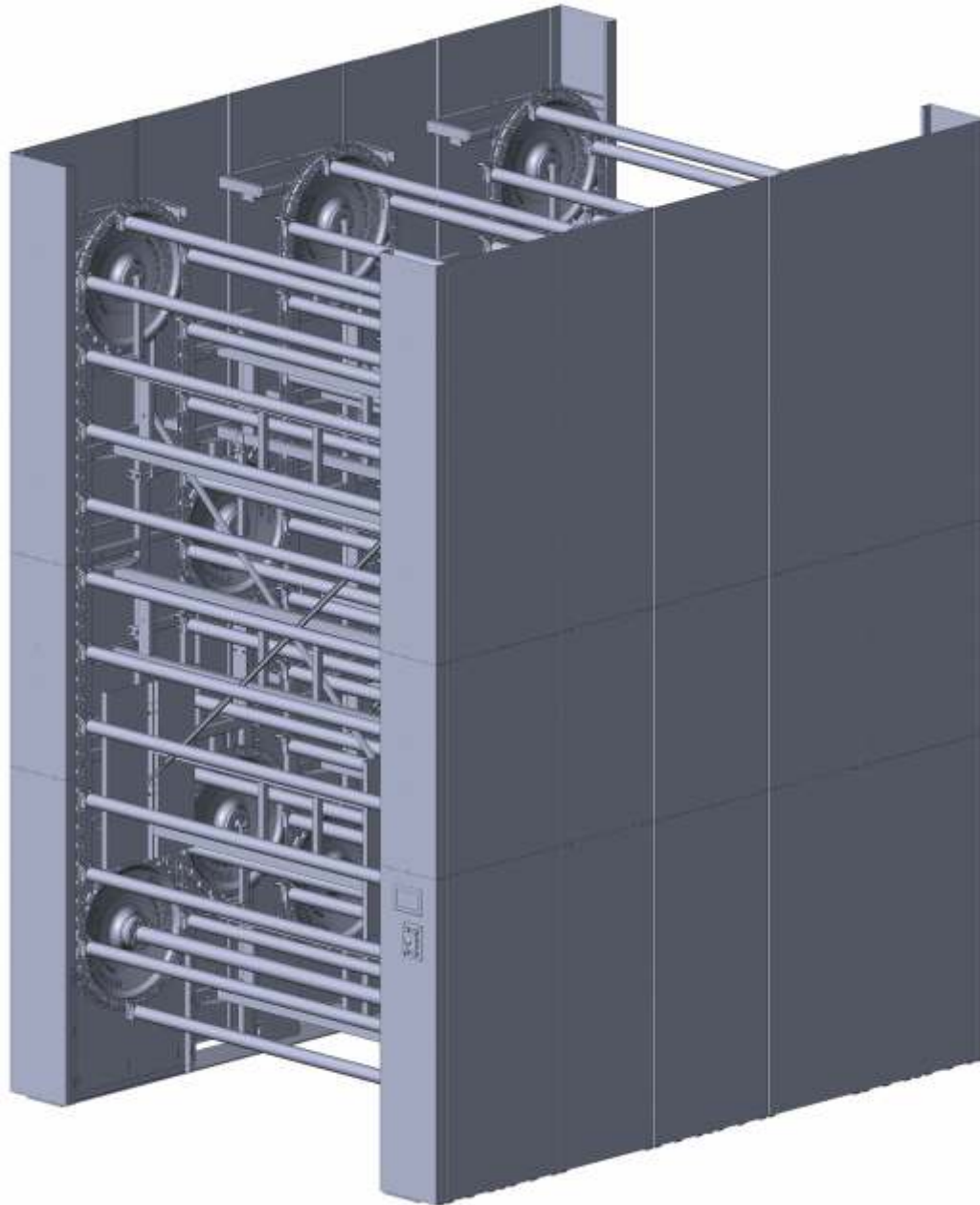
**MULTI-ROW PATERNOSTER FOR ROLLED MATERIALS «SLADOCK» M3**

| Number of rolls d580 mm | Conditional paternoster height H, mm | Paternoster overall height (per roll), mm | Carpet width, mm |            |            |            |            |            |            | Drive power, kW / V |
|-------------------------|--------------------------------------|---|------------------|------------|------------|------------|------------|------------|------------|---------------------|
|                         |                                      |   | Vendor code      |            |            |            |            |            |            |                     |
|                         |                                      |   | 2000             | 2500       | 3000       | 3500       | 4000       | 4500       | 5000       |                     |
| 44                      | 5000                                 | 5080                                      | A205044M3M       | A255044M3M | A305044M3M | A355044M3M | A405044M3M | A455044M3M | A505044M3M | 2x1,5/380           |

| Number of rolls d380 mm | Conditional paternoster height H, mm | Paternoster overall height (per roll), mm | Carpet width, mm |            |            |            |            |            |            | Drive power, kW / V |
|-------------------------|--------------------------------------|---|------------------|------------|------------|------------|------------|------------|------------|---------------------|
|                         |                                      |   | Vendor code      |            |            |            |            |            |            |                     |
|                         |                                      |   | 2000             | 2500       | 3000       | 3500       | 4000       | 4500       | 5000       |                     |
| 67                      | 5000                                 | 5080                                      | A205067M3M       | A255067M3M | A305067M3M | A355067M3M | A405045M3M | A455067M3M | A505067M3M | 2x1,5/380           |

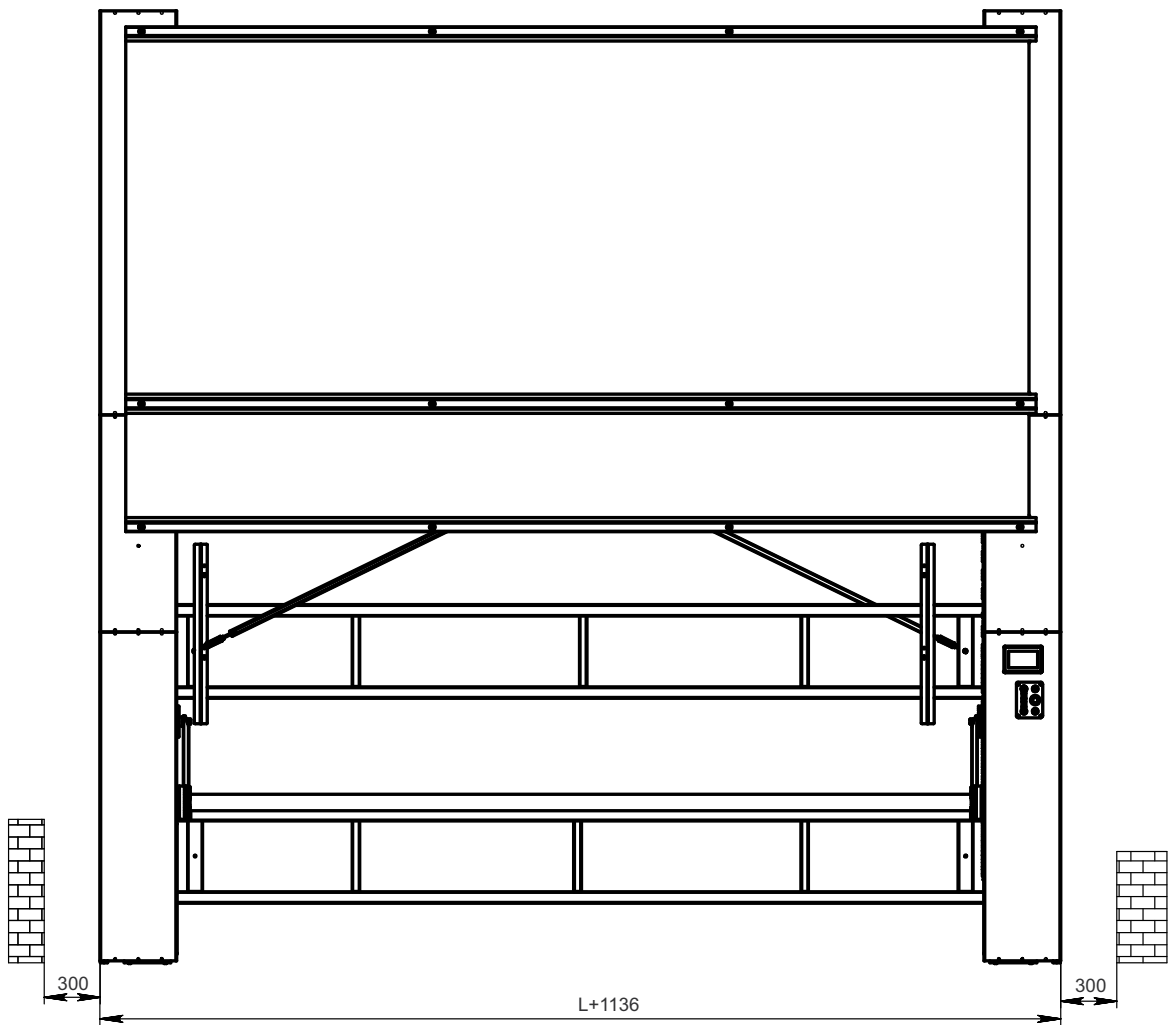

| Roll width, mm | Paternoster width, mm | Paternoster depth, mm |
|----------------|-----------------------|-----------------------|
| 2000           | 3136                  | 4064                  |
| 2500           | 3636                  |                       |
| 3000           | 4136                  |                       |
| 3500           | 4636                  |                       |
| 4000           | 5136                  |                       |

Paternoster Sladock M3 expands its technical capabilities by increasing the number of rolls and adding an additional demonstration area to access the product from the opposite side of the equipment.

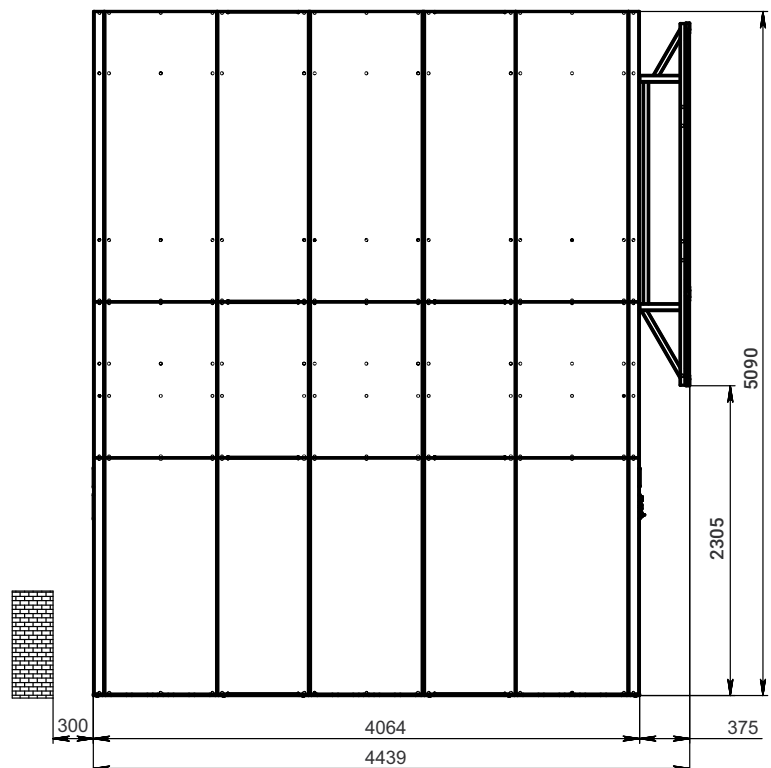



**PATERNOSTER AUTOMATED CONTROL SYSTEM**

The paternoster automated control system is designed to supply the selected roll to the consumer, and also allows you to assign the desired article to each type of floor covering.

The installation is based on the «Delta 7» touch panel and an integrated programmable controller.

The system is controlled by the operator using buttons, as well as a panel - for displaying the status and entering data.

Button control completely duplicates the automatic feed system.



| The name of indicators  | Unit  | Meaning    |
|---|-------|------------|
| Linear speed of the chain   | m/min | 5          |
| Maximum permissible roll diameter   | mm    | 600        |
| Maximum permissible roll weight   | kg    | 280        |
| Maximum difference between the weight of rolls on opposite sides of the paternoster | kg    | 600        |
| Total power of the installed electric motors Paternoster motor (gear- motor)        | kW    | 1,5; 2,2   |
| Total power of installed electric motors Sladock M2 and M3 (2 gear- motors)         | kW    | 1,5; 2x1,5 |
| Nominal supply voltage  | V     | 220/380    |
| Rated current frequency   | Hz    | 50         |

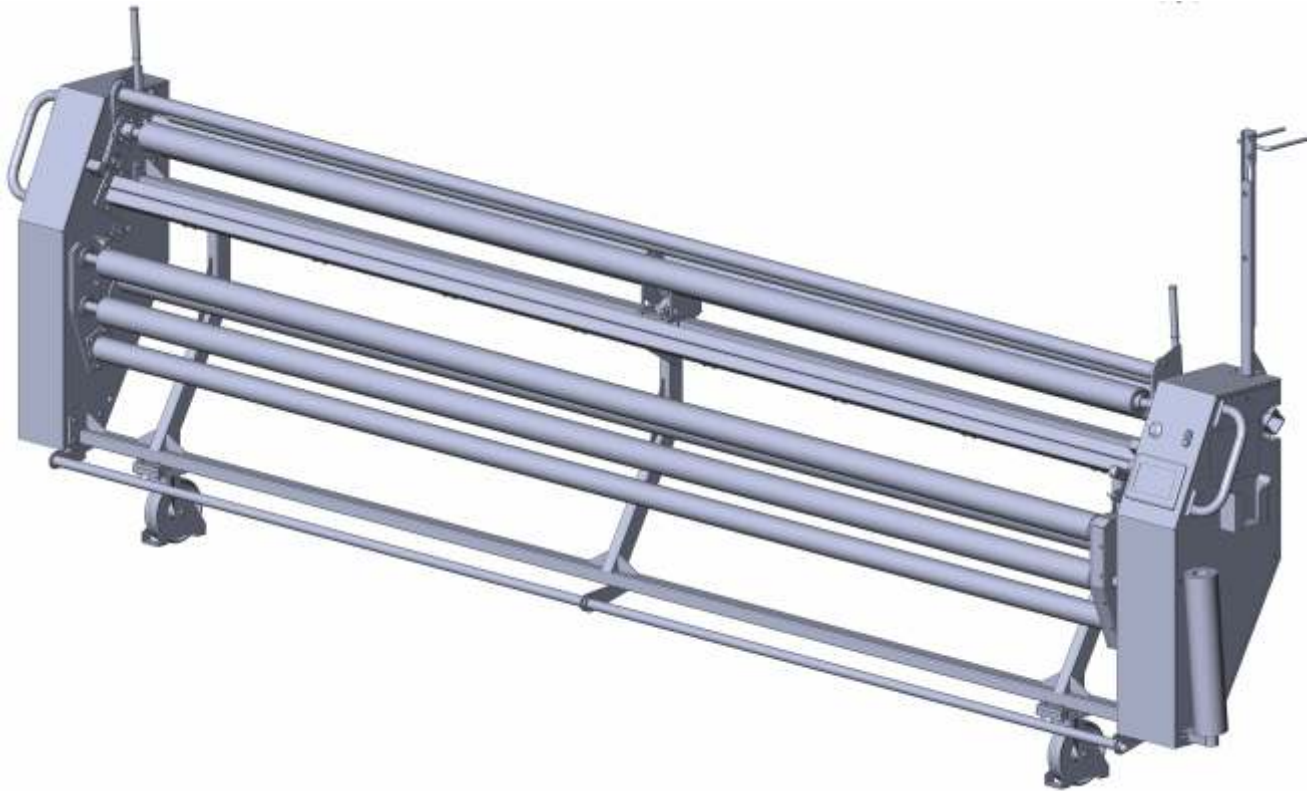

**MOBILE CUTTING DEVICE**

| Vendor code | Name  |
|-------------|---|
| F400070     | Electrical measuring machine for measuring, cutting floor coverings 4 m wide. Electronic programmable counter, adjustment for the type and thickness of the floor covering. |
| CUT4000     | Knife for cutting floor coverings   |

Mobile cutting device - is an electrical measuring device for measuring and cutting floor coverings from an electric paternoster or other storage device.

The length is counted using an electronic angular displacement sensor (encoder), which ensures high counting accuracy (maximum deviation).



Acceptable roll diameter 300 mm



Acceptable roll weight 200 kg

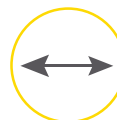

Maximum roll width 4000 mm



Display accuracy +/- 0.5%



Voltage 220 V



The cutting device is equipped with a guide with a slot for a knife, with the help of which a straight and fast cutting of the coating with a hand knife is carried out, without maximum effort.

Indication, access control, office are implemented using an industrial touch panel. The programmable panel controller allows you to implement additional functions for accounting and control of material residues.

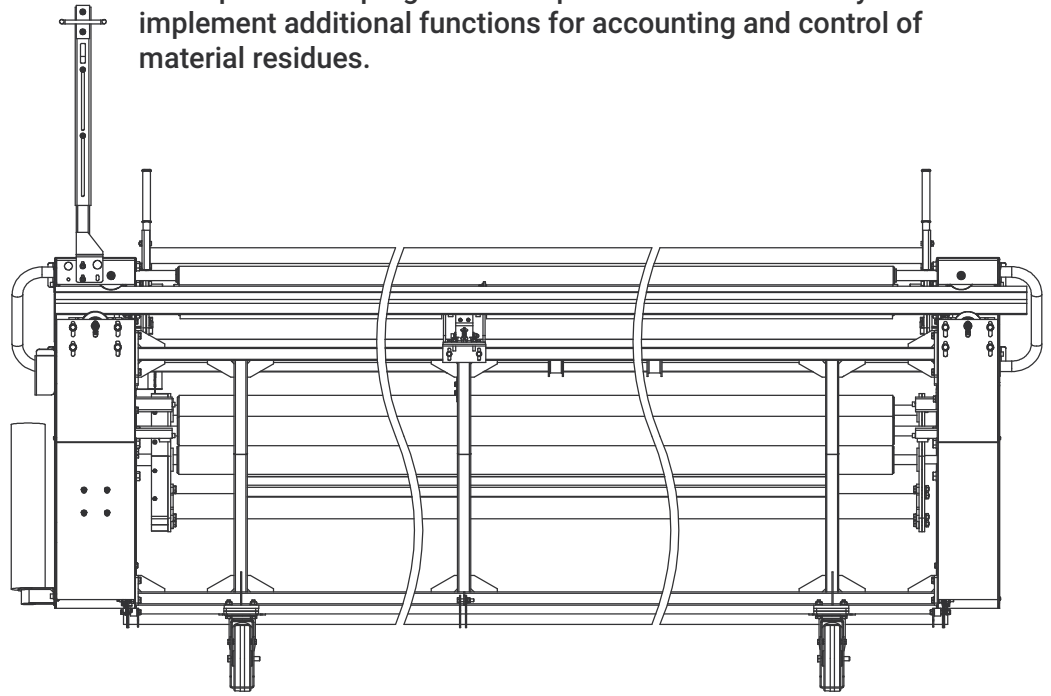
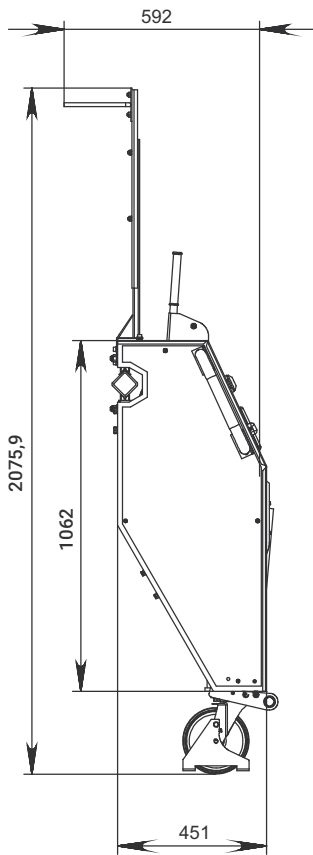

The device is powered through a movable trolley-type closed busbar, which allows the device to move along a row of serviced equipment, provides the device with mobility and operational safety.

The device is equipped with special brackets for storing the used packaging material and easy access to them.



**ADVERTISING MODULE FOR SAMPLES ON PATERNOSTER**

| Vendor code | Length (L) mm |
|-------------|---------------|
| BP0042.2000 | 2000          |
| BP0042.2500 | 2500          |
| BP0042.3000 | 3000          |
| BP0042.3500 | 3500          |
| BP0042.4000 | 4000          |
| BP0042.5000 | 5000          |

Advertising module for samples on Paternoster - is a structure with elements for fastening samples, which is mounted on the facade of the paternoster and performs the function of protection.

**REAR SAFETY SCREEN FOR PATERNOSTER**

| Vendor code | Length (L) mm |
|-------------|---------------|
| BP0042.2000 | 2000          |
| BP0042.2500 | 2500          |
| BP0042.3000 | 3000          |
| BP0042.3500 | 3500          |
| BP0042.4000 | 4000          |
| BP0042.5000 | 5000          |

Rear safety screen - a structure that is mounted on the back of the paternoster and serves as a protective shield.



### CUTTING BAR FOR PATERNOSTER WITHOUT COUNTER

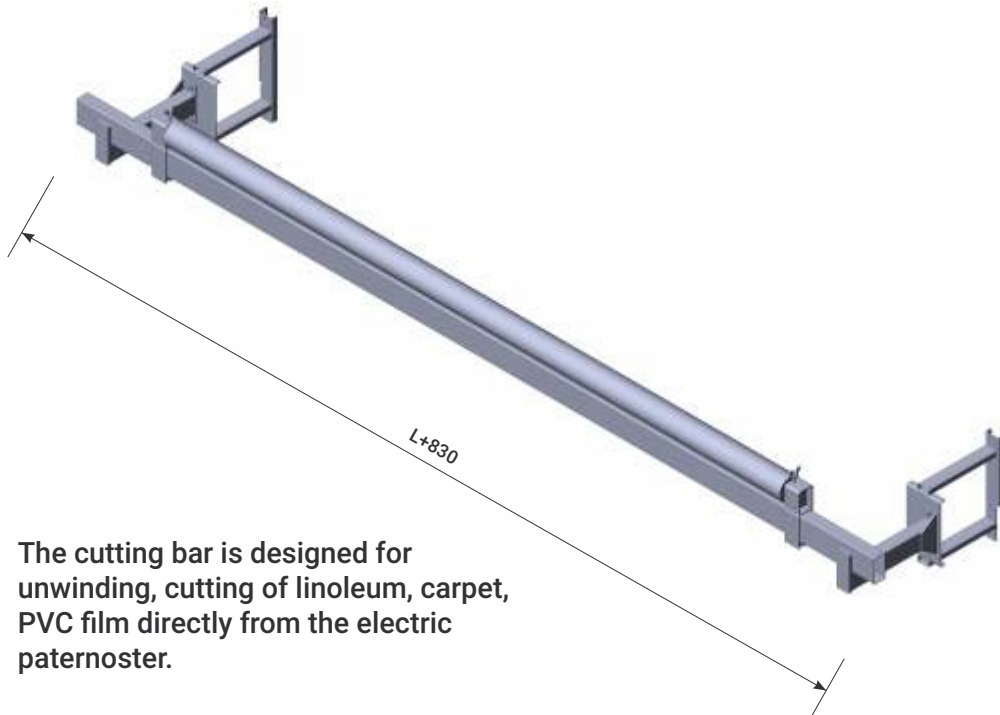

| Vendor code | Length (L), mm |
|-------------|----------------|
| FNB2000     | 2000           |
| FNB2500     | 2500           |
| FNB3000     | 3000           |
| FNB3500     | 3500           |
| FNB4000     | 4000           |
| FNB5000     | 5000           |

The cutting bar is designed for unwinding, cutting of linoleum, carpet, PVC film directly from the electric paternoster.

### PROTECTIVE FLANGE

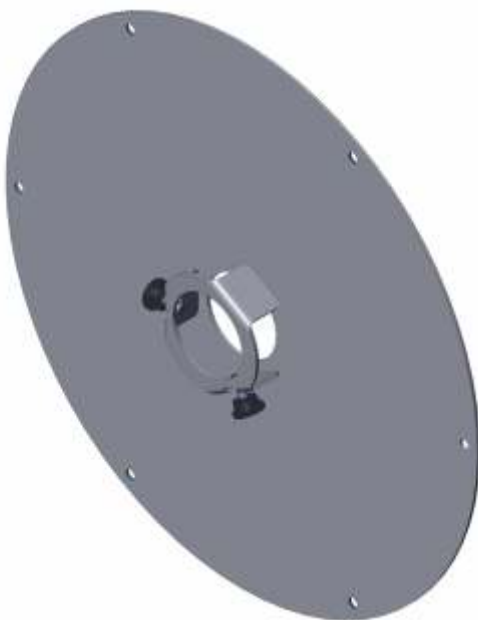

| Vendor code  | Name   |
|--------------|--|
| BP0006X_60mm | Protective flange 60/540 for carpet rolls on a shaft 60 mm to paternoster, black color |
| BP0006X_76mm | Protective flange 76/540 for carpet rolls on a shaft 76 mm to paternoster, black color |

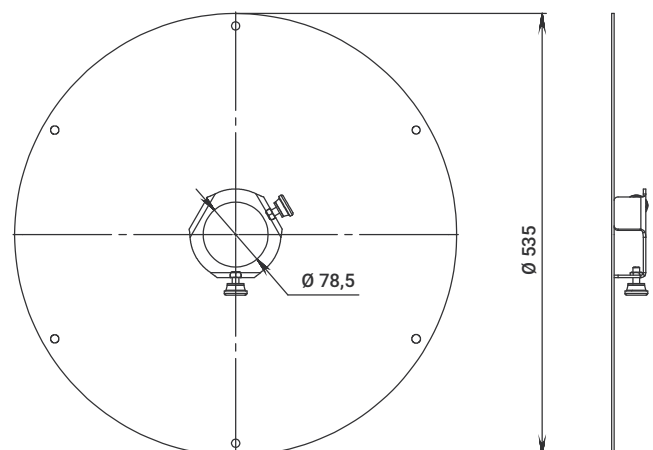

Serves as a protective element for carpet rolls from getting threads into the paternoster device, as well as for fixing the roll

PROTECTION OF THE FACADE CLADDING OF PATERNOSTER



|             |
|-------------|
| Vendor code |
| BP0034X     |

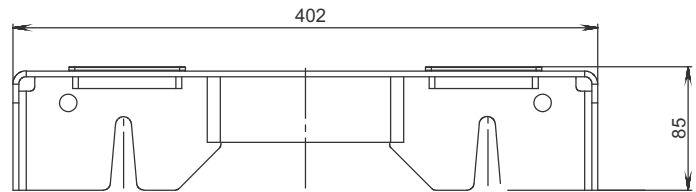

PROTECTION OF THE CORNER CLADDING OF THE PATERNOSTER

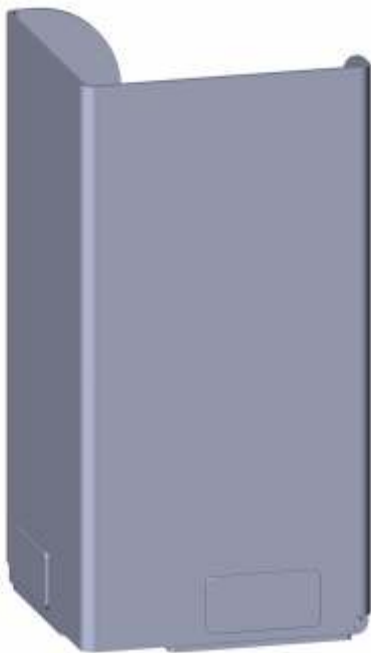

|             |
|-------------|
| Vendor code |
| BP0035X     |

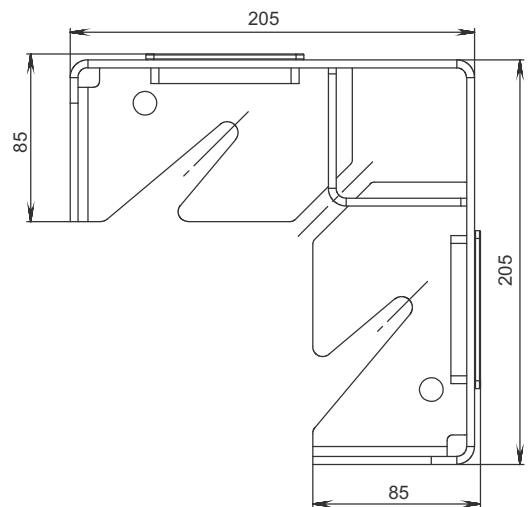

**BELT FOR FIXING ROLLS**



| Vendor code | Name                                     |
|-------------|--|
| E110110     | Belt for fixing carpet, diameter 610 mm  |
| E110120     | Belt for fixing linoleum diameter 350 mm |

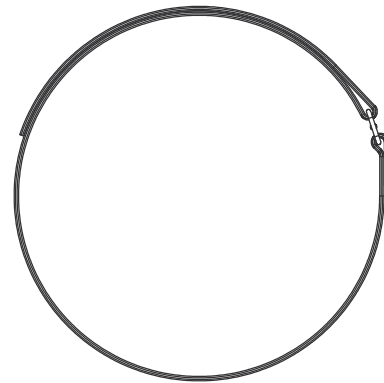

**ROLL MATERIAL LOADING TROLLEY**

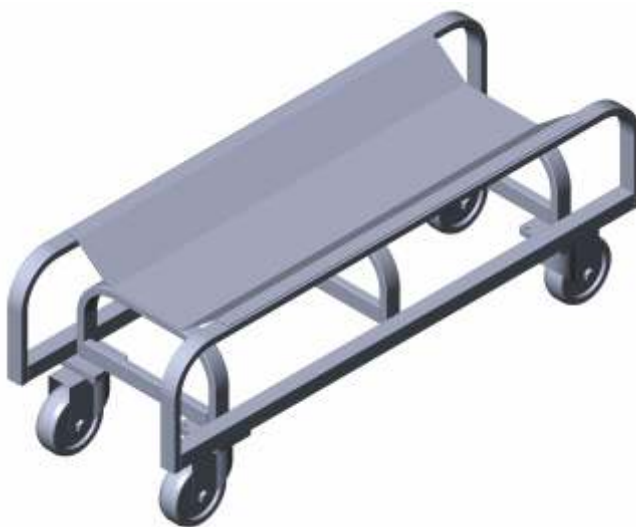

| Vendor code |
|-------------|
| EP0065X     |



**Carrying capacity up to 400 kg**



**Wheel diameter 150 mm**

It is recommended to transport rolls over 3000 mm wide with two trolleys.

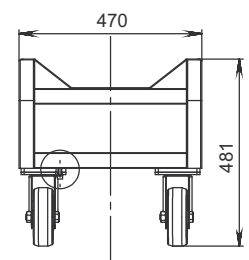
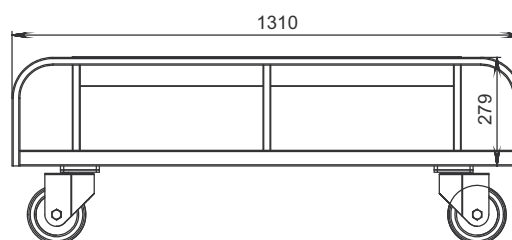

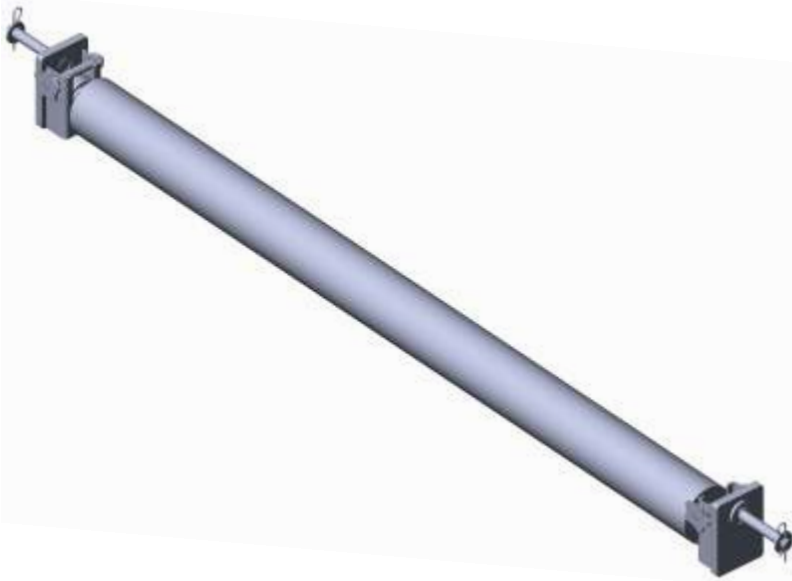
**TRANSPORT SHAFTS FOR PATERNOSTER TYPE SLADOCK (ON BEARINGS)**

| Vendor code | Name   |
|-------------|--|
| SL200020CE  | Additional shaft 2 m, complete with supports (SLADOCK)   |
| SL250020CE  | Additional shaft 2,5 m, complete with supports (SLADOCK) |
| SL300020CE  | Additional shaft 3 m, complete with supports (SLADOCK)   |
| SL350020CE  | Additional shaft 3,5 m, complete with supports (SLADOCK) |
| SL400020CE  | Additional shaft 4 m, complete with supports (SLADOCK)   |
| SL500020CE  | Additional shaft 5 m, complete with supports (SLADOCK)   |

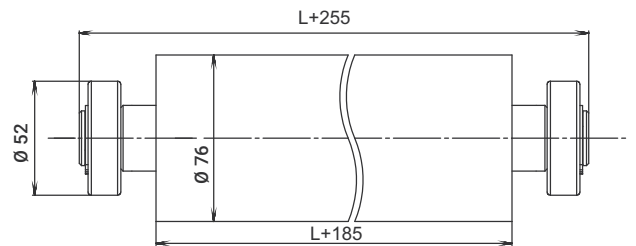
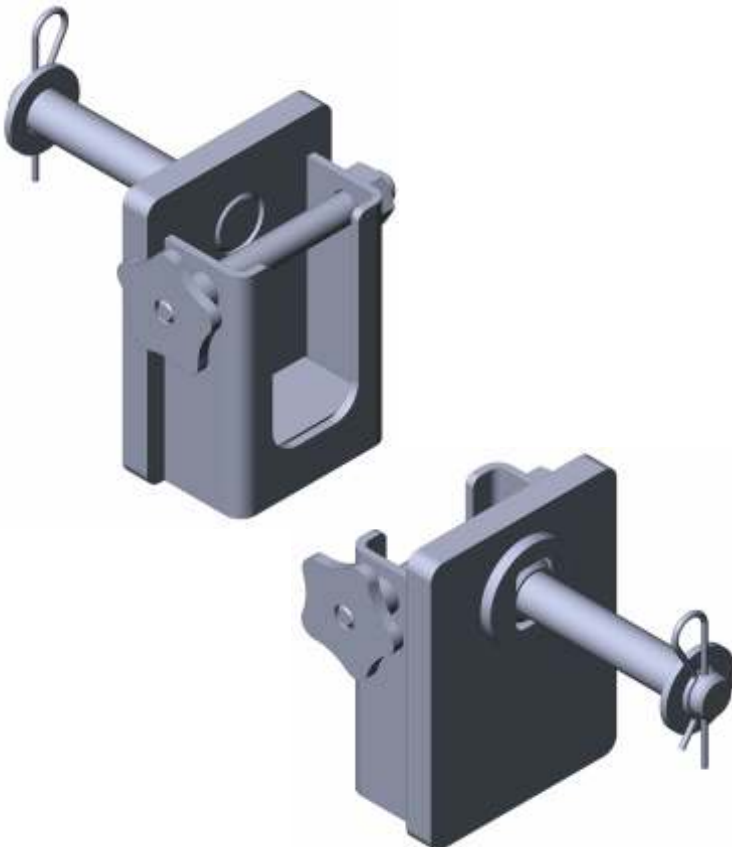
**SUPPORT OF THE TRANSPORT SHAFT FOR PATERNOSTER TYPE SLADOCK (ON BEARINGS)**

| Vendor code | Name                              |
|-------------|-----------------------------------|
| SL110040P   | Transport shaft support (Sladock) |

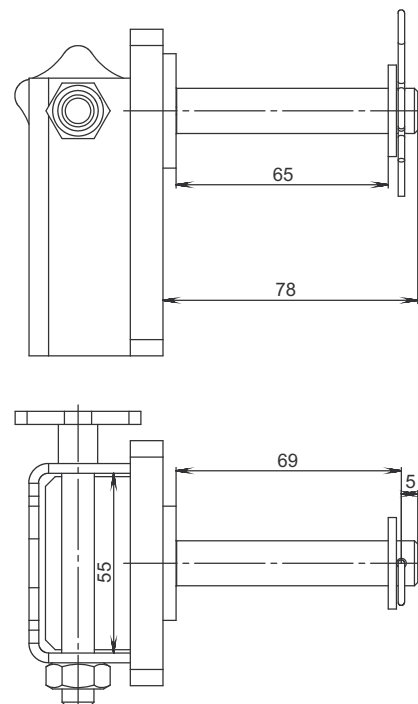

PATERNOSTER TRANSPORT SHAFTS

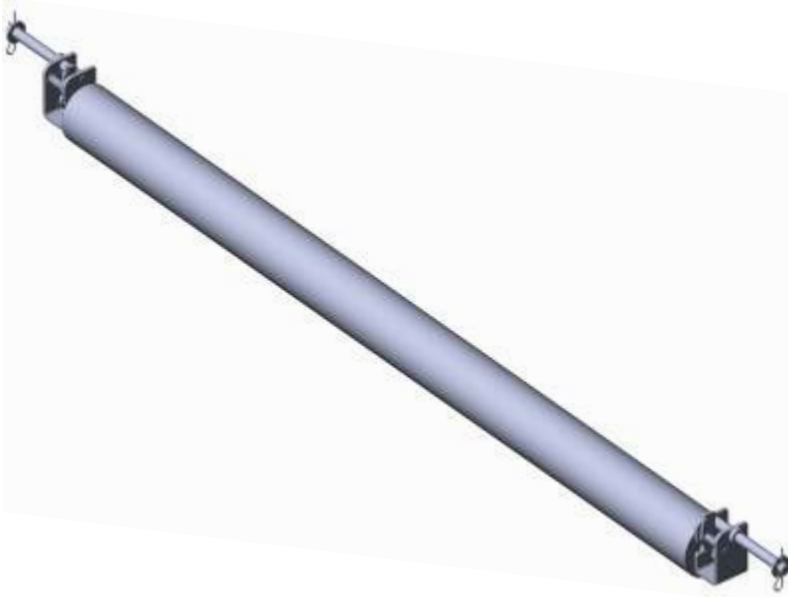

| Vendor code | Name   |
|-------------|--|
| B200020CE   | Additional shaft 2 m, complete with supports   |
| B250020CE   | Additional shaft 2,5 m, complete with supports |
| B300020CE   | Additional shaft 3 m, complete with supports   |
| B350020CE   | Additional shaft 3,5 m, complete with supports |
| B400020CE   | Additional shaft 4 m, complete with supports   |
| B500020CE   | Additional shaft 5 m, complete with supports   |

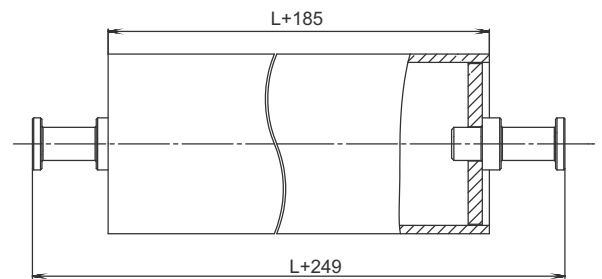

TRANSPORT SHAFT SUPPORT

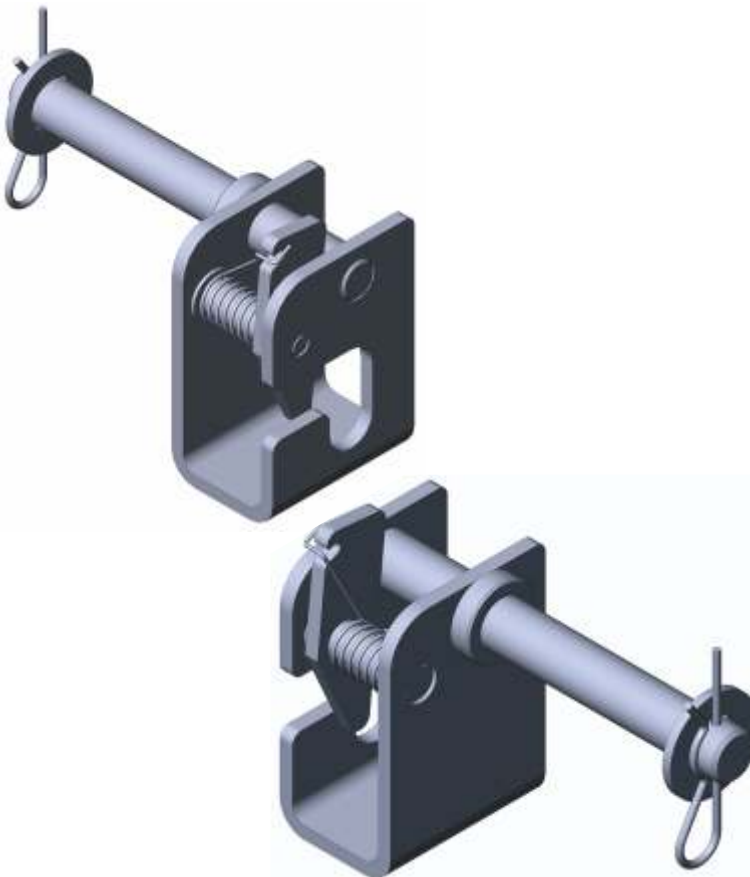

| Vendor code | Name                    |
|-------------|-------------------------|
| B110040P    | Transport shaft support |

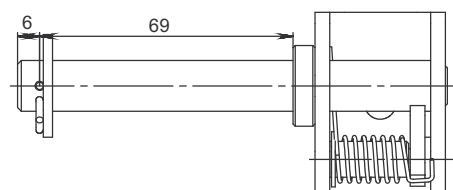
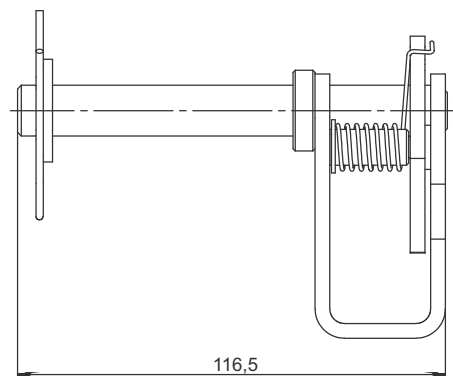



## ISPAHAN STAND

Ispahan stand is designed for vertical display of carpets.



| Vendor code  | Name   |
|--------------|--|
| BAXE1724_40  | Ispahan stand, 40 carpets 1.7 * 2.4 clamp tongs, complete with podium B695 2705*1895*2565*1800 (A*B*C*D) |
| BAXE1724_50  | Ispahan stand, 50 carpets 1.7 * 2.4 clamp tongs, complete with podium B696 2705*1895*2565*1800 (A*B*C*D) |
| BAXE22030_40 | Ispahan stand, 40 carpets 2*3 clamp tongs, complete with podium B695 3305*2195*2065*2100 (A*B*C*D)       |
| BAXE2030_50  | Ispahan stand, 50 carpets 2*3 clamp tongs, complete with podium B695 3305*2195*2065*2100 (A*B*C*D)       |
| BAXE2535_20  | Ispahan stand, 20 carpets 2,5*3,5 clamp tongs, complete without podium 3780*2695*2065*2600 (A*B*C*D)     |
| BAXE2535     | Ispahan stand, 40 carpets 2,5*3,5 clamp tongs, complete without podium 3780*2695*2065*2600 (A*B*C*D)     |

The construction of the expositor consists of two support frames, a lower headroom, a base and cantilever guides (pages). The carpet is hung on both sides of the guides with clamps.

The guides are equipped with elements that prevent the carpet from being removed with clips, to prevent accidental or deliberate removal of the hanging elements.

## ADDITIONAL FORCEPS

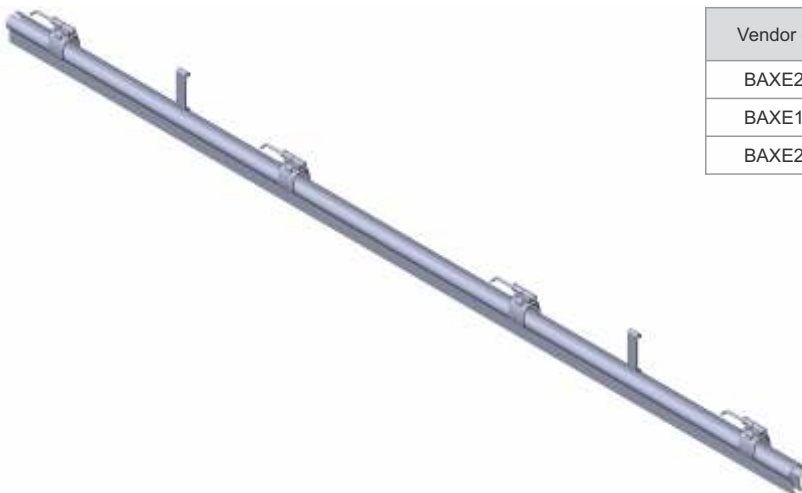

| Vendor code | Name                           |
|-------------|--------------------------------|
| BAXE2000    | Carpet stand forceps 2,0 extra |
| BAXE1700    | Carpet stand forceps 1,7 extra |
| BAXE2500    | Carpet stand forceps 2,5 extra |



A series of horizontal dotted lines spanning the width of the page, intended for taking notes.



Dotted lines for writing notes.



Ukraine, Kharkiv, 61106, 12, Plytkova street,  
tel.: +38 (057) 744-10-00, e-mail: [info@ipris-profil.com](mailto:info@ipris-profil.com)  
[www.ipris-profil.com](http://www.ipris-profil.com)